



ELECTROSWITCH
UNIT OF ELECTRO SWITCH CORP.
WEYMOUTH, MASSACHUSETTS 02188
TEL: (781) 335-5200 FAX: (781) 335-4253

INSTALLATION & USAGE GUIDE PUSH TO TURN HANDLE KIT (SERIES W2)

824-IUG-W2

NOT TO SCALE

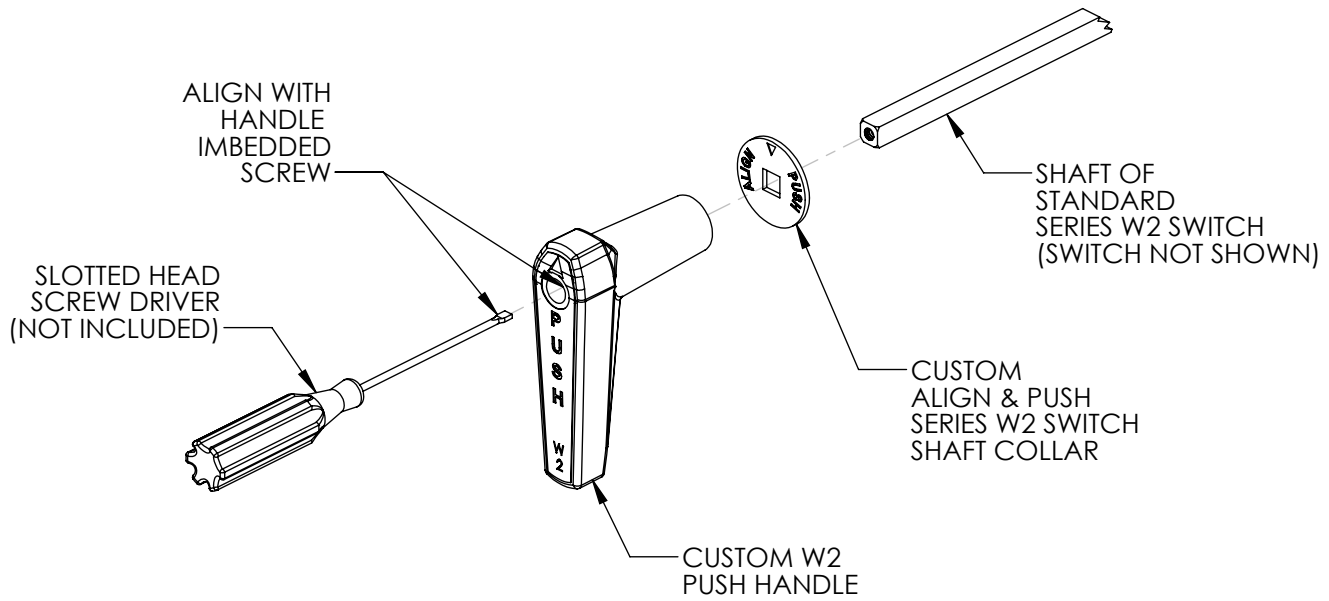

INSTALLATION:

1. REMOVE OLD SWITCH HANDLE
2. ALIGN FLAT OF COLLAR WITH SWITCH SHAFT AND SLIDE OVER SWITCH SHAFT
MAKE SURE "ALIGN & PUSH" WORDING FACES HANDLE AS SHOWN
3. ALIGN HANDLE WITH SWITCH SHAFT AND PUSH ONTO SHAFT
4. USE SCREW DRIVER (NOT INCLUDED) TO INSTALL SCREW HANDLE ONTO SWITCH SHAFT

SWITCH ACTIVATION

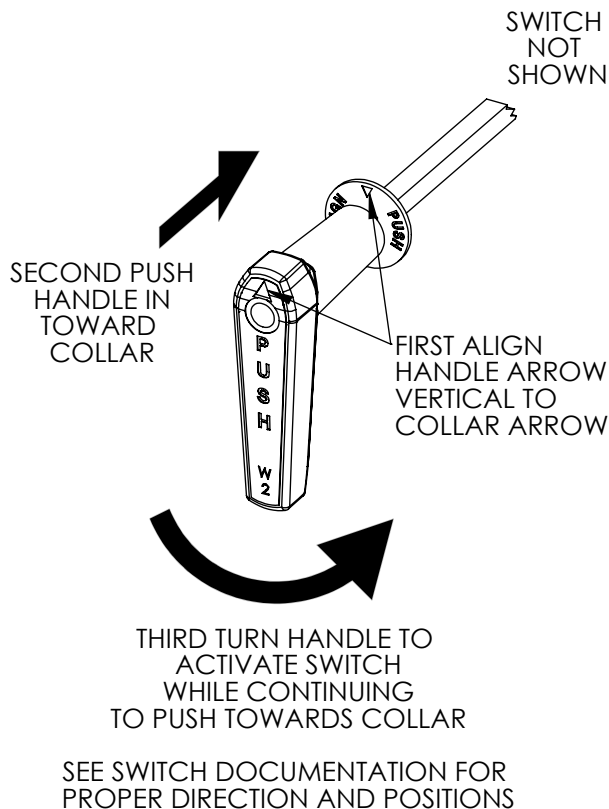

SWITCH HANDLE IN FREE STATE

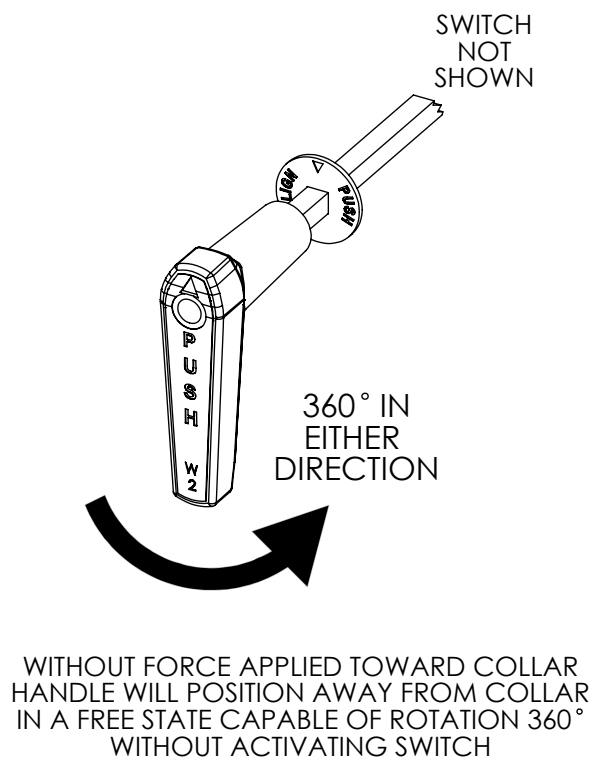

REVISIONS:

MADE BY: E.S.M.
APPR. BY: S.B.

DATE: 02-27-2019
DATE:

DWG. NO: 824-IUG-W2
SHEET 1 OF 1

REV 0