

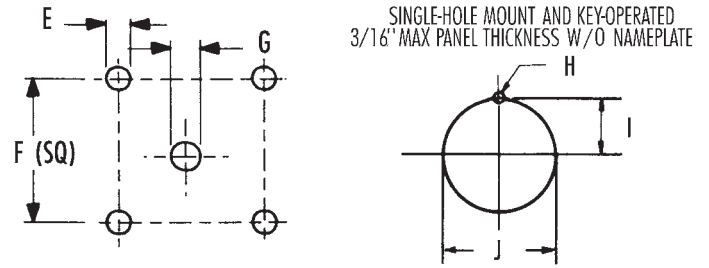

# CAM-ACTION ROTARY SWITCHES

## DIMENSIONS

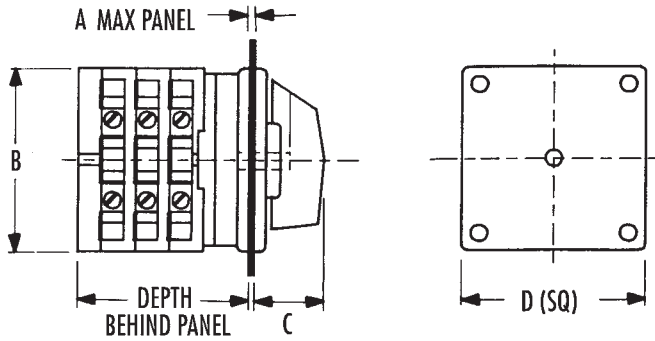

CAM-ACTION ROTARY SWITCH DIMENSIONS (INCHES)										
SERIES	A	B	C	D	E	F	G	H	I	J
KW12	.188	1.77	1.10	1.97	.18	1.42	.47	.118	.59	1.18
KW16	.188	2.36	1.22	2.56	.18	1.89	.47	.118	.59	1.18
KW20	.188	1.77	1.10	1.97	.18	1.42	.47	.118	.59	1.18
KW25	.188	2.36	1.22	2.56	.18	1.89	.47	.118	.59	1.18
KW32	.188	2.36	1.22	2.56	.18	1.89	.47	.118	.59	1.18
KW40	.188	2.36	1.22	2.56	.18	1.89	.47	.118	.59	1.18
KW63	.125	2.99	1.58	3.70	.22	2.68	.47	-	-	-
KW100	.125	3.30	1.58	3.70	.22	2.68	.47	-	-	-
KW200	.250	4.72 x 4.33	2.44	5.04	.26	4.25	.63	-	-	-
KW400	.250	4.72 x 4.33	2.44	5.04	.26	4.25	.63	-	-	-
KW600	.250	4.72 x 4.33	2.44	5.04	.26	4.25	.63	-	-	-
KW800	.250	4.72 x 4.33	2.44	5.04	.26	4.25	.63	-	-	-

DEPTH BEHIND PANEL DIMENSIONS												
SERIES	NO. OF DECKS											
	1	2	3	4	5	6	7	8	9	10	11	12
KW12*	1.48	1.93	2.38	2.83	3.28	3.74	4.19	4.65	5.10	5.55	6.00	6.45
KW16*	1.95	2.51	3.07	3.63	4.19	4.75	5.31	5.86	6.43	6.98	7.54	8.10
KW20*	1.48	1.93	2.38	2.83	3.28	3.74	4.19	4.65	5.10	5.55	6.00	6.45
KW25*	1.95	2.51	3.07	3.63	4.19	4.75	5.31	5.86	6.43	6.98	7.54	8.10
KW32*	2.09	2.78	3.46	4.15	4.84	5.53	6.22	6.91	7.60	8.29	8.98	9.67
KW40*	2.09	2.78	3.46	4.15	4.84	5.53	6.22	6.91	7.60	8.29	8.98	9.67
KW63	2.43	3.22	4.00	4.79	5.58	6.37	7.15	7.94	8.73	9.52	10.30	11.09
KW100	2.80	3.86	4.92	5.96	7.01	8.07	9.10	10.16	11.22	12.26	13.31	14.37
KW200	3.74	5.31	6.89	8.46	10.04	11.61	13.19	14.76	16.34	17.91	19.49	21.06
KW400**	-	5.31	6.89	8.46	10.04	11.61	13.19	14.76	16.34	17.91	19.49	21.06
KW600**	-	5.31	6.89	8.46	10.04	11.61	13.19	14.76	16.34	17.91	19.49	21.06
KW800**	-	5.31	6.89	8.46	10.04	11.61	13.19	14.76	16.34	17.91	19.49	21.06

\*For Single Hole Mount, increase dimensions on KW12 and KW20 by .12", and on KW16, 25, 32, and 40 by .52".  
 For Key Operation, increase dimensions on KW12 and KW20 by .75", and on KW16, 25, 32, and 40 by 1.20".  
 \*\*Depth behind panel is determined by the current rating required and the paralleling of 200A decks. The switch cannot exceed 12 decks.  
 Please contact factory in regard to your application.

### FLUSH POINTER HANDLE

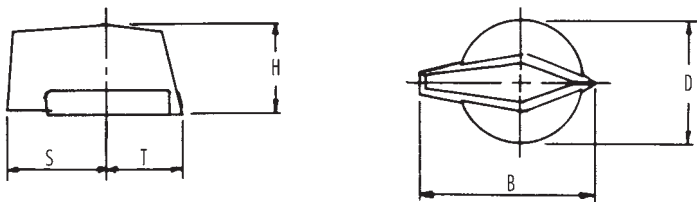

HANDLE DIMENSIONS					
SERIES	D	H	T	S	B
KW12, 20	1.06	0.79	0.67	0.87	1.54
KW16, 25, 32, 40	1.42	0.99	0.83	1.14	1.97
KW63, 100	1.81	1.26	1.10	1.65	2.76
KW200-800	3.00	1.97	1.77	2.44	4.22

### BALL TIP HANDLE

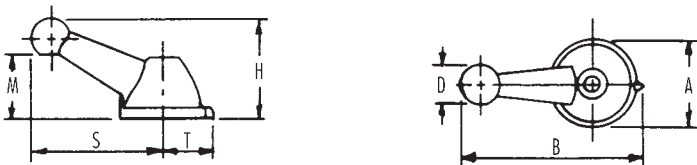

HANDLE DIMENSIONS							
SERIES KW	S	T	B	M	H	A	D
16, 25, 32, 40	2.56	0.87	3.43	1.26	1.89	1.46	0.71
63-100	NOT AVAILABLE						
200-800	4.33	1.61	5.94	2.05	3.19	2.83	1.26

### T - HANDLE, KW200 - 800 ONLY

